

Project Case Study

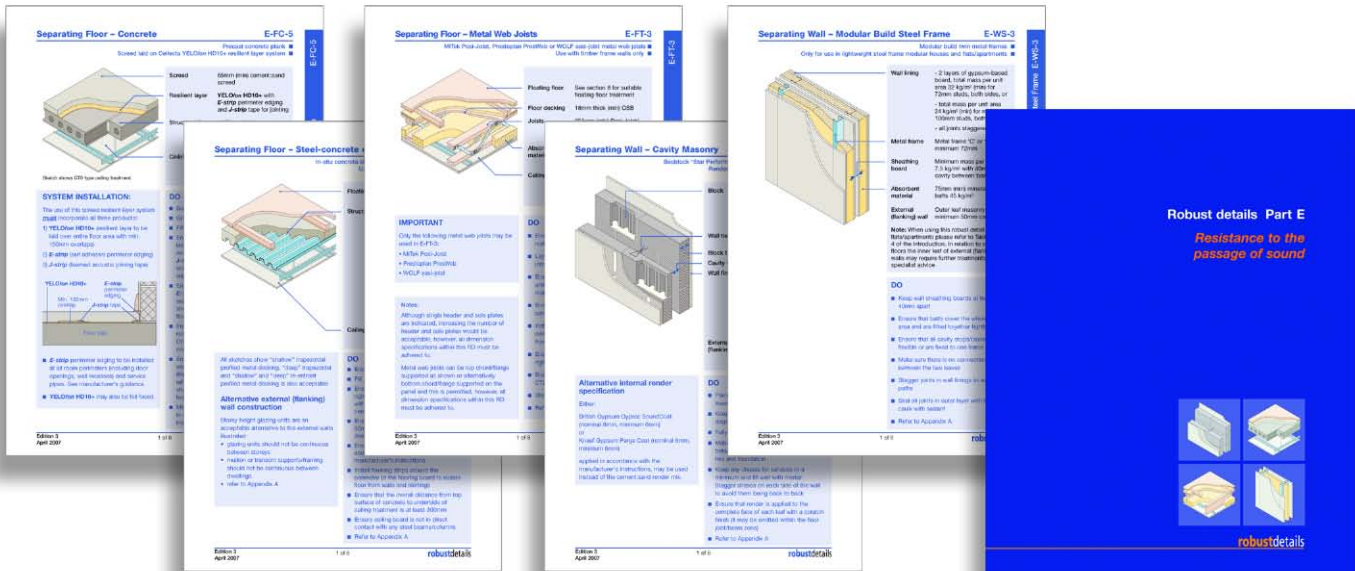

The Robust Details Handbook contains robust details for Part E of the Building Regulations: Resistance to the passage of sound.

Client

Robust Details Ltd.

The Project

Robust Details Ltd has been set up to approve and issue Robust Standard Details (RSDs). RSDs are constructional details that have been tested for compliance with Building Regulations Approved Document E, and can be used in place of the details contained within.

The ring binder contains a series of approved details that can be used safely without any requirement for 'pre-completion sound testing'. Consequently there is no risk of incurring additional costs and delays arising from a need for remedial work after work is complete.

NBAT were invited to produce a template for setting out the specification and technical drawings in a clear and concise way.

The binder and 114 pages had to be produced within a tight time scale. This required close co-operation between NBAT and staff at NHBC. As constructions were drawn up and laid out in Quark, they were e-mailed as pdfs with comments added using the drawing tools. This method of working proved very quick and efficient with new constructions being turned round and amendments made in a couple of days.

Objectives

To ensure an acceptable level of sound performance it was important that the information about each robust detail was set out as clearly and simply as possible with no room for ambiguity – good clear communication.

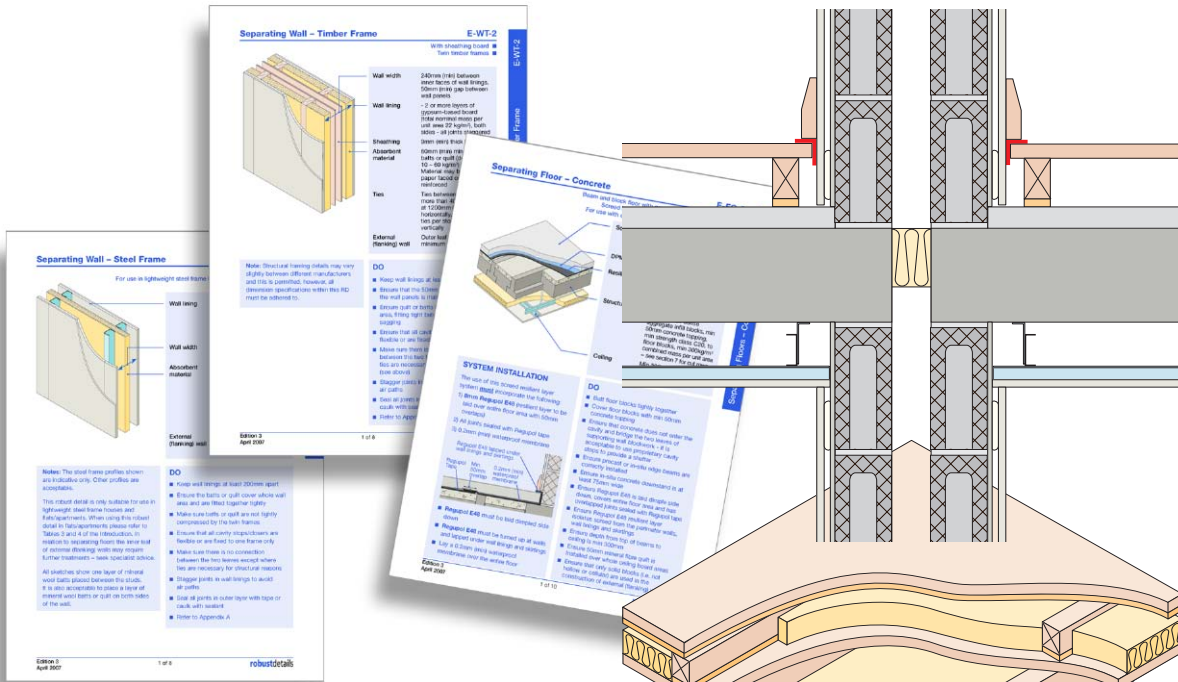

Work undertaken

- Project management and client liaison.
- Graphic design concept and layout.
- Production of all technical illustrations.
- Artwork and print management.

Feedback

The binder Robust Details Part E is the first issued robust details publication. It was well received by the client. Robust Details Ltd is a newly-launched organisation and will continuously monitor the 'as-built' details. A scheme exists where interested parties can submit proposals for new robust details for inclusion in the handbook.

