

# Project Case Study

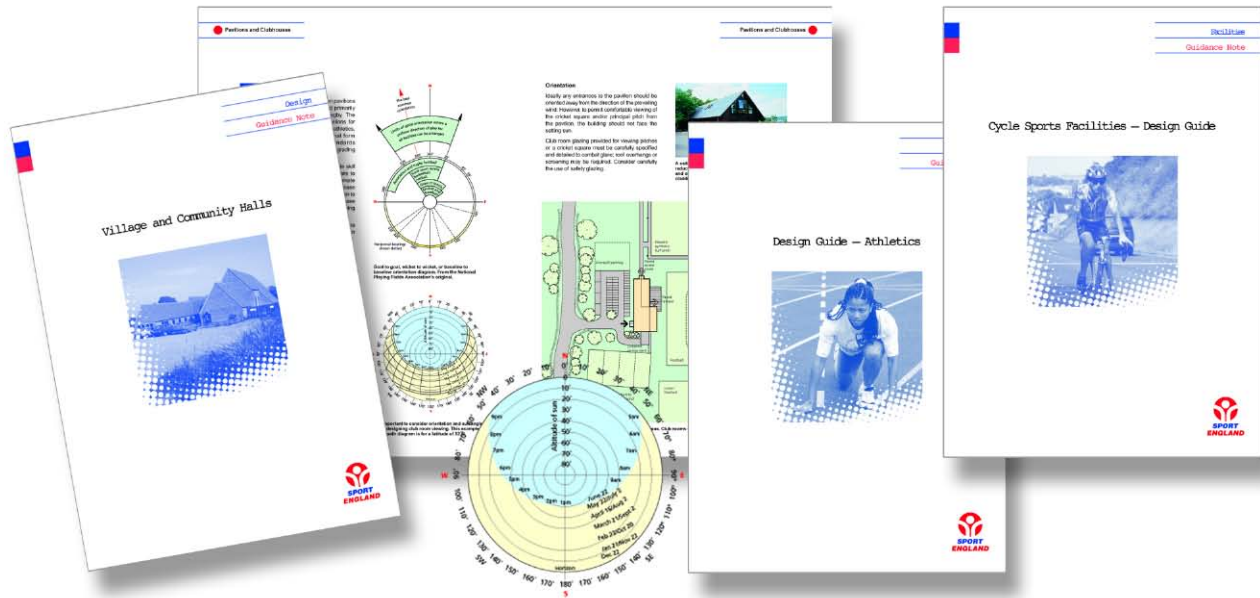

A series of documents providing detailed technical guidance on the planning of sports facilities and buildings.

## Client

Sport England.

## The Project

Because of its architectural knowledge and understanding, NBAT was invited to undertake all of the technical illustrations, in addition to formatting the layout of each document.

The wide-ranging series of individual technical documents covers:

- Sports halls – sizes and layouts.
- Village and community halls.
- Pavilions and clubhouses.
- Athletics design guide.
- Changing rooms and lockers

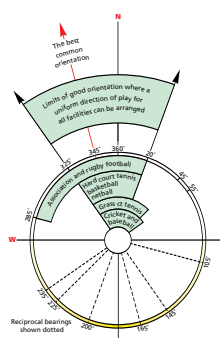

- Car parking and landscape design.
- Access for disabled people.
- Cycling sports facilities.
- Floors for indoor sports.
- Indoor bowls.
- Swimming pools.
- Badminton.
- Artificial lighting.
- Natural turf for sport.
- Construction project management.

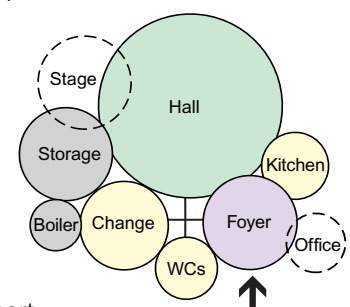

Each document provides clear guidance to the rationale underlying successful sports provision.

